

# Vertical Blinds Installation Instructions

**You will need:** Pencil, tape measure, drill, screwdriver, pliers, and appropriate fasteners

## 1 | Locate installation screws



1/2" #8 hex head wood screws (included)  
Alternative fasteners should be used for metal, brick, tile or concrete installations (not included)

## 2 | Valance installation

### Outside Mount Installation

Snap the plastic valance clips onto the aluminum headrail. Then slide the top of the valance into the plastic valance clips until they lock in place.

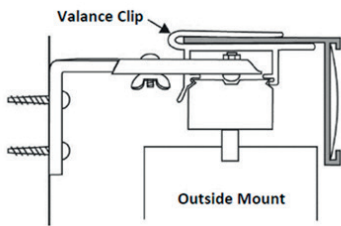

### Inside or Ceiling Mount Installation

Install the headrail bracket clip mounting screw through the valance as shown. Make sure louvers do not touch the valance.  
**Note:** No valance clips are needed for inside mount installations.

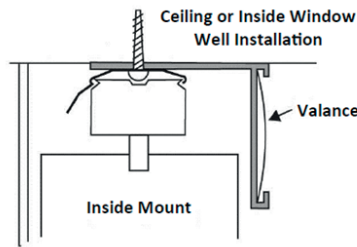

### Valance Returns

If the valance returns are not preassembled, slide the clear plastic corner clip onto the top edge of the valance. Then slide the valance return into the other side of the corner clip as shown to the right. Valance returns may be trimmed to fit using a heavy-duty scissors.

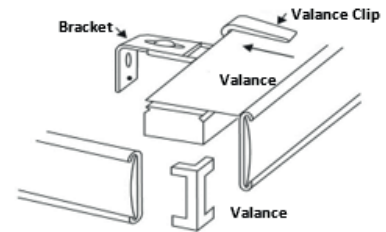

## 3 | Bracket installation

Before installing, review the chart below to confirm the correct number of brackets per blind.

Up to 54"	54 1/8" - 84"	84 1/8" - 94"
2	3	4

### Outside Mount (Fig. A)

Standard wall mount installation brackets are adjustable and provide 1/2" to 1 1/2" wall clearance. Determine the height for the top of the bracket (measured from the floor) by adding 1/2" to the blind height including the headrail. When installed, louvers will clear the floor by 1/2".

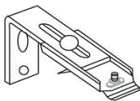

Place the first bracket directly over the corner of the window with a maximum space of 30" between the remaining brackets. Adjust the brackets so the louvers clear all obstructions.

### Inside or Ceiling Mount (Fig. B or C) Blinds with Valance – Install the Valance first

Use mounting clips to secure headrail on ceiling or inside mounts. The center of the mounting clips align with the center of the louver carrier stem. Position the screws a minimum of 2 1/4" in front of the window frame or any projection.



Set mounting clips with a maximum space of 30" between clips. Allow a minimum of 1/2" clearance above the sill or carpet.

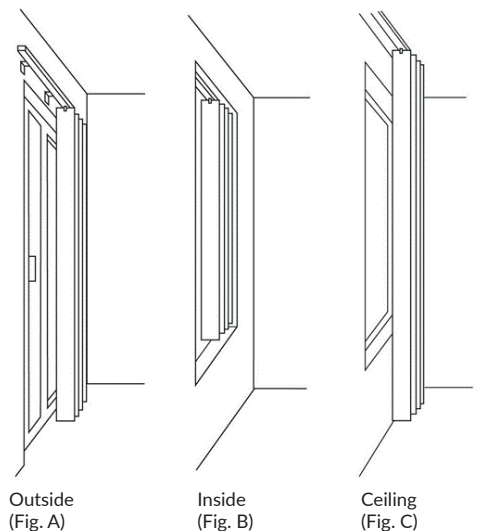

## 4 | Headrail installation

Mount the installation brackets on the headrail then snap into place as shown to the right. To remove headrail, simply push the release lip up with a screwdriver.

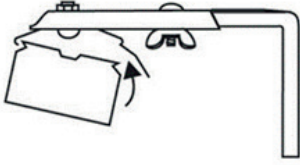

## 5 | Louver installation

Push the louver up into the carrier stem. Then pull slightly straight down to lock in place. For wand options, if the louvers are curved, the curved side should face the wand.

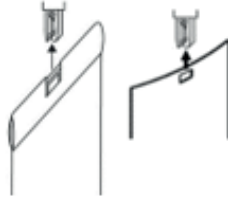

## 6 | Test louver rotation

This step will align the louvers.



**Wand Control:** Turn the wand in the direction you want the louvers to rotate.

## 7 | Test traverse

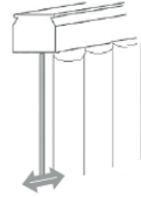

**Wand Control:** Rotate the louvers to the open position then push or pull the wand to open (stack louvers) or close (unstack louvers) the blind.

**Caution:**

Do not traverse the blind with the louvers in the closed position

### Wand Control Operating Instructions

To rotate the louvers, rotate the wand in the direction you want the louvers rotated. To traverse the louvers, rotate the louvers to the open position. Then, push or pull the wand to open (stack louvers) or close (unstack louvers) the blind. If louvers are installed with the front of the louver facing the wand, the wand will be in front of the louvers when the blind is rotated closed. If the louvers are installed with the back of the louver facing the wand, the wand will be behind the louvers when the blind is rotated closed.

### Tips for Preventing Louver Misalignment

Avoid leaving the window open during inclement, windy weather. Completely open (traverse) the blinds before opening the window. Do not allow children or pets to pass through the closed blind.